

YZF Shaded Pole Motors

YZF Serisi fan motorları

YZF serisi fan motorları 4 kutuplu monofaze asenkron fan motorlarıdır. Çalışma voltajı 220-240 V/50 -60 Hz veya 110-120 V/ 60 Hz dir. Yaygın olarak kondanseler, evaporatörler ve diğer soğutma cihazlarında kullanılırlar.ROHS standardına uygun malzemelerden imal edilmiştir.Çıkış gücü 2 W dan 34 W a kadardır ve stator genişliği, sarğı parametreleri gibi detaylara bağlıdır.Fan motorlarının izolasyon sınıfı B dir ve IP42 korumalıdır. İsteğe bağlı olarak IP44 koruması da mevcuttur. Çıkış gücü 10W altındaki tüm fan motorları embedans(iç direnç) korumalıdır. 10 W ve üzeri tüm fan motorları ise termik korumalıdır. Termik sıcaklık dayanımı $125^{\circ}\text{C} \pm 5^{\circ}\text{C}$, $135^{\circ}\text{C} \pm 5^{\circ}\text{C}$ veya $150^{\circ}\text{C} \pm 5^{\circ}\text{C}$ dir.Fan motorlarımızın çalışılabilir ortam ısısı -30°C ile 50°C arasında değişebilmektedir.Standart fan motorlarımız manyetik yataklı olduklarından shaft yere paralel olarak montaj yapmayı tavsiye ediyoruz. Talep üzerine bu ürünler rulmanlı olarak da tedarik edilebilir.Fan motorlarımız için ortalama çalışma ömrü 20000 saatin üzerindedir.Fan motorlarımız modellerine bağlı olarak CE ,VDE, UL sertifikalarına sahip olup CCC güvenlik onayından da geçmiştir.Fanı çalıştırmadan önce topraklama kablosunu uygun şekilde toprak hattına bağılandırdığınızdan emin olunuz.

Model Adlandırması / Illustration of model

YZF 5 - 13 - 18

2 vida arası boşluk
Space between the two screws

Lamine çekirdeğin kalınlığı
Thickness of laminated core

Model kodu(çıkış gücü)
Model code

Monofaze ve değişken akımlı gölge kutuplu motorlar
Shaded pole motors with single phase and alternating current

YZF26 Fan Motorları Shaded Pole Motors

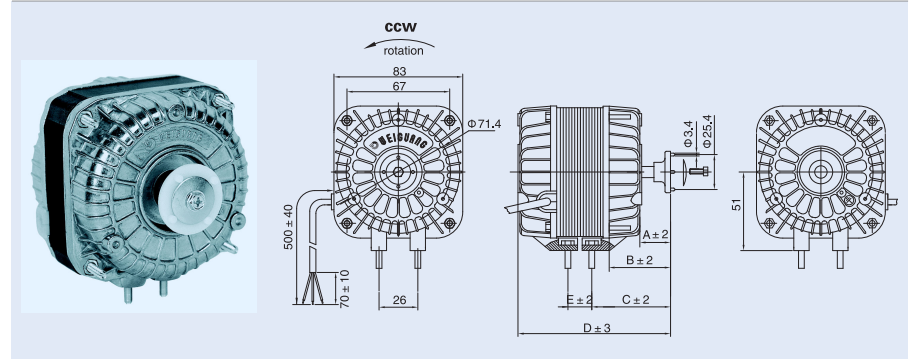

YZF18 Fan Motorları Shaded Pole Motors

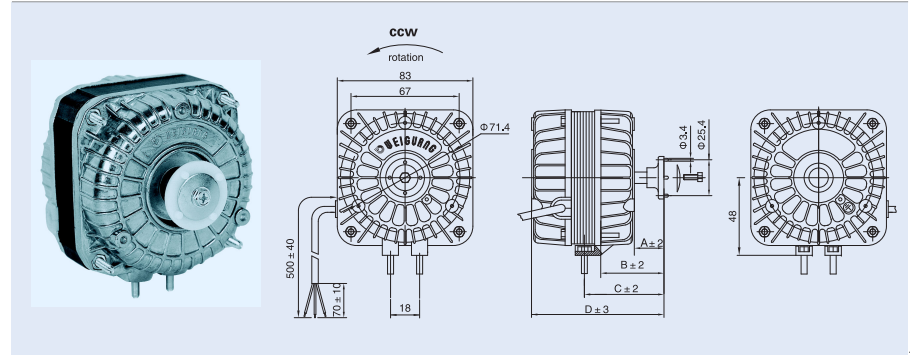

YZF18/26 Fan Motorları Shaded Pole Motors

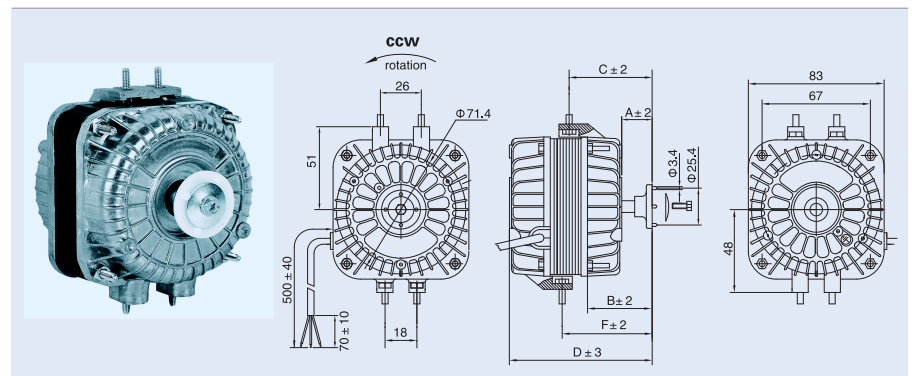

YZFOO Fan Motorları / Shaded Pole Motors

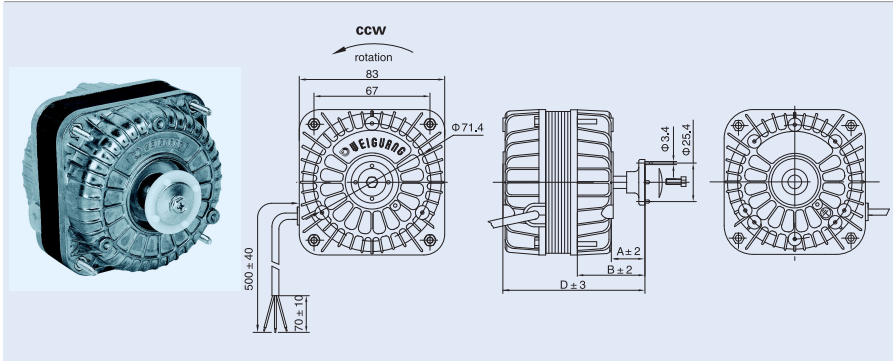

YZF-P Soketli Fan Motorları / With Pin Terminal Motors

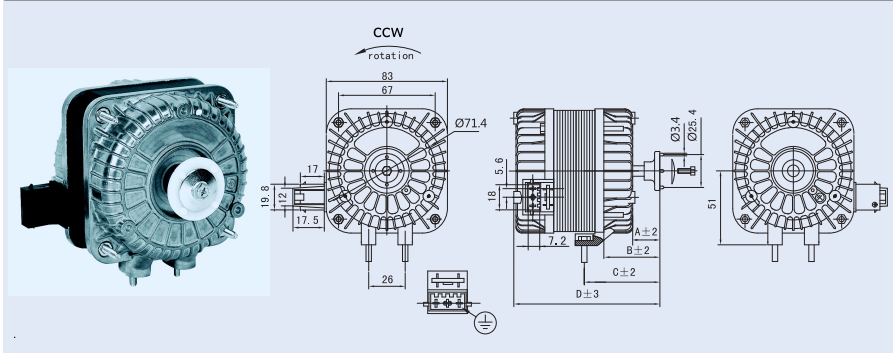

YZF Soketli Kablolu Fan Motorları / Motors with plug

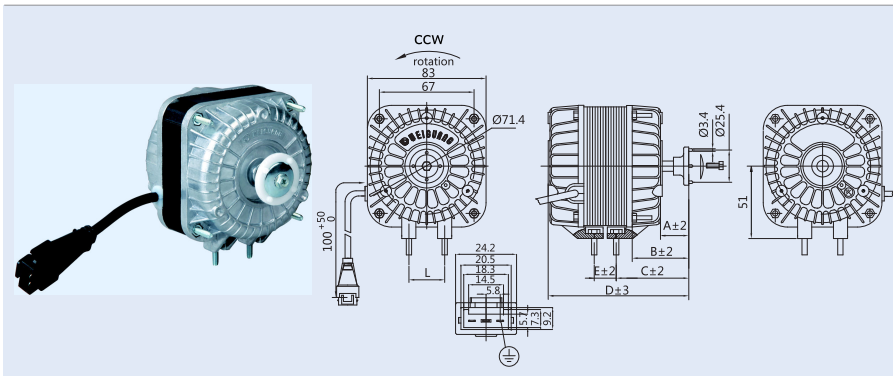

Specification Teknik Özellikler

TYPE MODEL	VOLTAGE VOLTAJ	FREQUENCY FREKANS	RATED INPUT GİRİŞ GÜCÜ	OUT PUT ÇIKIŞ GÜCÜ	RATED CURRENT AKIM	RATED SPEED HIZ	AIR VOLUME DEBİ	FAN BLADE PERVANE CAPI	NET WEIGHT AĞIRLIK	A	B	C	D	E	F
	V	Hz	W	W	A	dev/dak	m³/saat	mm	kg	mm	mm	mm	mm	mm	mm
YZF 2-13	220-240	50/60	20	2	0.14	1300	205	Ø 172	0.8	16.5	35.5	46	81	-	45
YZF 5-13	220-240	50/60	29	5	0.20	1300	455	Ø 200	0.8	16.5	35.5	46	81	-	45
YZF 6-13	110-120	60	33	6	0.55	1550	510	Ø 230	1.1	16.5	35.5	46	87	-	51
YZF 7-20	220-240	50/60	31	7	0.23	1300	640	Ø 230	1.1	16.5	35.5	46	87	-	51
YZF10-20	220-240	50/60	36	10	0.25	1300	650	Ø 230	1.1	16.5	35.5	46	87	-	51
	110-120	60	55	10	0.80	1550	800	Ø 230	1.1	16.5	35.5	46	87	-	51
YZF12-20	220-240	50/60	54	12	0.36	1300	690	Ø 230	1.1	16.5	35.5	46	87	-	51
YZF16-25	220-240	50/60	60	16	0.45	1300	760	Ø 254	1.4	15.5	34.5	45	92	-	56
YZF18-25	110-120	60	70	18	1.01	1550	940	Ø 254	1.5	18	38	48.5	101	21	64.5
	220-240	50/60	70	18	0.50	1300	1000	Ø 254	1.5	18	38	48.5	101	21	64.5
	110-120	60	75	18	1.00	1450	1000	Ø 254	1.5	18	38	48.5	101	21	64.5
YZF25-40	220-240	50/60	90	25	0.70	1300	1030	Ø 300	1.8	19	39	49.5	112	31	75.5
	110-120	60	100	25	1.40	1450	1030	Ø 300	1.8	19	39	49.5	112	31	75.5
YZF34-45	220-240	50/60	110	34	0.85	1300	1210	Ø 300	2.0	23	43	53.5	121	36	84.5
	110-120	60	110	34	1.50	1450	1210	Ø 300	2.0	23	43	53.5	121	36	84.5

YZF Serisi Fan Motorları Montajı Installation of Shaded Pole Motor

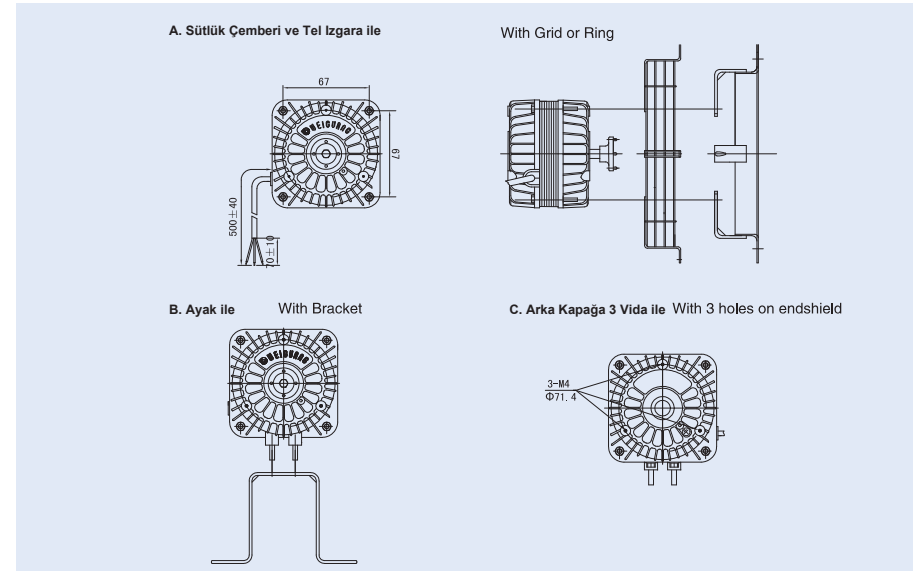

YCF Kapasitörlü Fan Motorları / Capacitance Motors

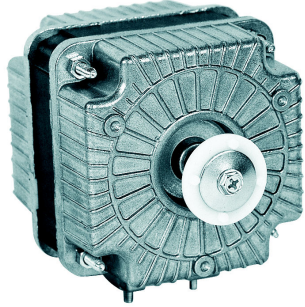

TYPE MODEL	VOLTAGE VOLTAJ	FREQUENCY FREKANS	RATED INPUT GİRİŞ GÜCÜ	OUT PUT ÇIKIŞ GÜCÜ	RATED CURRENT AKIM	RATED SPEED HIZ	AIR VOLUME DEBİ	CAPACITANCE KAPASİTE	FAN BLADE PERVAANE ÇAPI	NET WEIGHT AĞIRLIK	A	B	C	D
YCF10-13-4	230	50	40	10	0,20	1300	650	1	Φ230/25°	0,8	12	33	43	78
YCF20-20-2	230	50	55	20	0,25	2500	800	2	Φ200/28°	1,2	17	38	52,5	99
YCF20-20-4	230	50	50	20	0,25	1300	860	1,5	Φ254/31°	1,2	17	38	52,5	99
YCF40-25-2	230	50	115	40	0,45	2500	1140	3	Φ254/19°	1,4	17	38	52,5	104
YCF30-30-2	230	50	140	30	0,60	2500	1400	3	Φ254/28°	1,6	17	38	52,5	109
YCF30-30-4	230	50	75	30	0,35	1300	1280	2	Φ300/28°	1,6	17	38	52,5	109
YCF80-50-2	230	50	200	80	0,75	2500	1930	8	Φ300/19°	2,5	28	49	63,5	140
YCF60-50-4	230	50	120	60	0,55	1300	1970	3	Φ300/34°	2,5	28	49	63,5	140

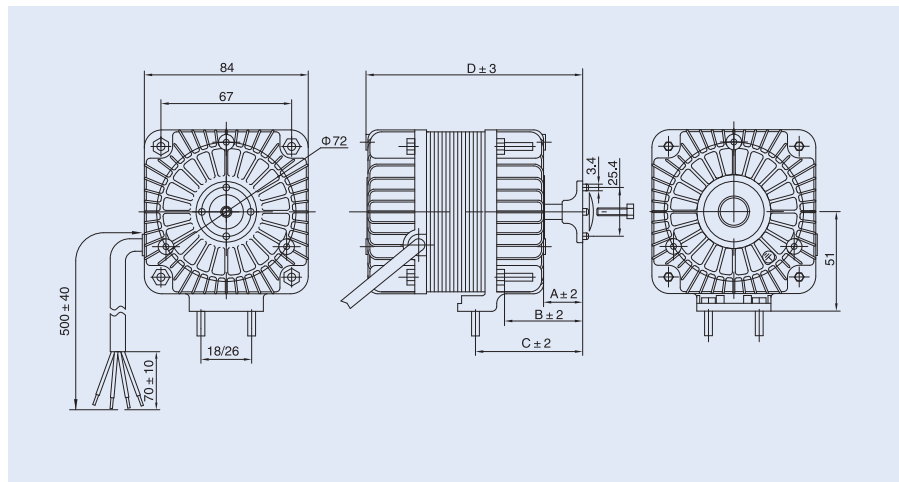

YZF Fan Motorları Hava Debileri / Air Flow

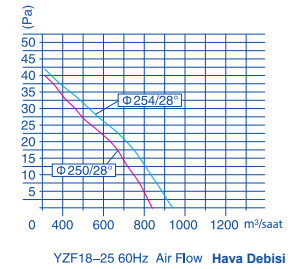
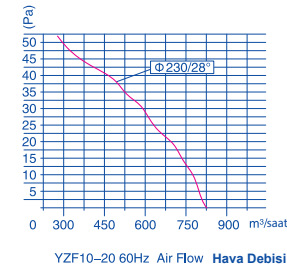
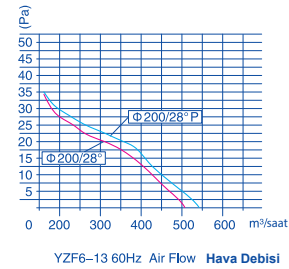
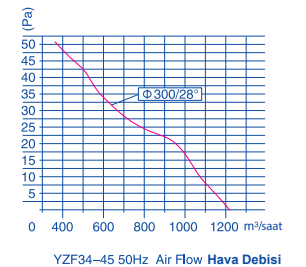
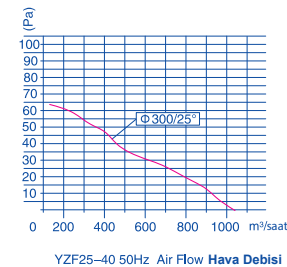
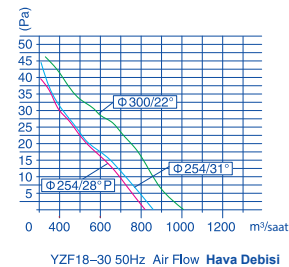
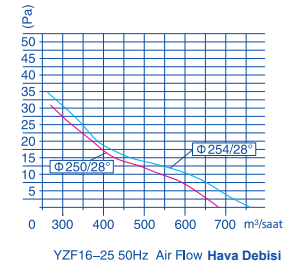
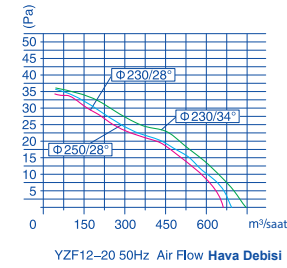
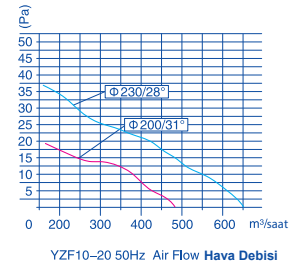
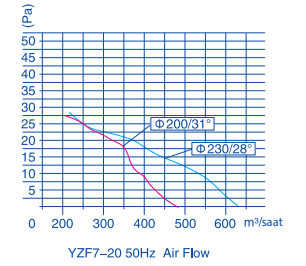
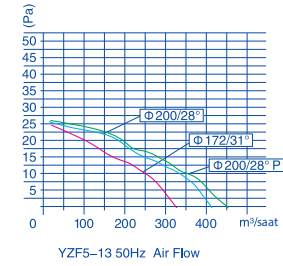
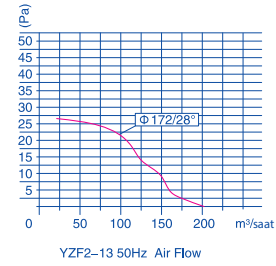

FAN BLADE / PERVANELER

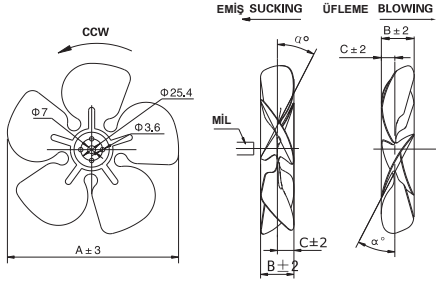

FAN TIP	α		19°		22°		25°		28°		31°		34°	
	A	ΦC	B	C	B	C	B	C	B	C	B	C	B	C
Φ 154	154	23	12	26	13	29	15	32	17	36	18	39	21	
Φ 172	172	25	13	28	14	31	16	34	17	38	18	41	21	
Φ 200	198	27	14	30	15	33	17	36	19	40	21	43	24	
Φ 230	230	30	15	33	16	36	19	39	21	42	20	45	23	
Φ 250	248	31	15	34	16	37	19	40	20	43	21	45	22	
Φ 254	254	32	15	35	16	38	18	41	21	44	22	47	23	
Φ 300	298	31	16	35	17	41	21	44	22	48	25	52	27	

TIP	α		YZF2-13		YZF5-13		YZF7-20		YZF10-20		YZF12-20		YZF16-25		YZF18-30		YZF25-40		YZF34-45		
	50Hz	60Hz	50Hz	60Hz	50Hz	60Hz	50Hz	60Hz	50Hz	60Hz	50Hz	60Hz	50Hz	60Hz	50Hz	60Hz	50Hz	60Hz	50Hz	60Hz	
Φ 154	28	28																			
Φ 172	28	28	31	31																	
Φ 200			28	28	31	31	31	31													
Φ 230					28	28	28	28	34	31											
Φ 250							22	22	28	28			28	28							
Φ 254											28	25		31	28						
Φ 300											22	22	25	22	28	25					



GRID / TEL IZGARA

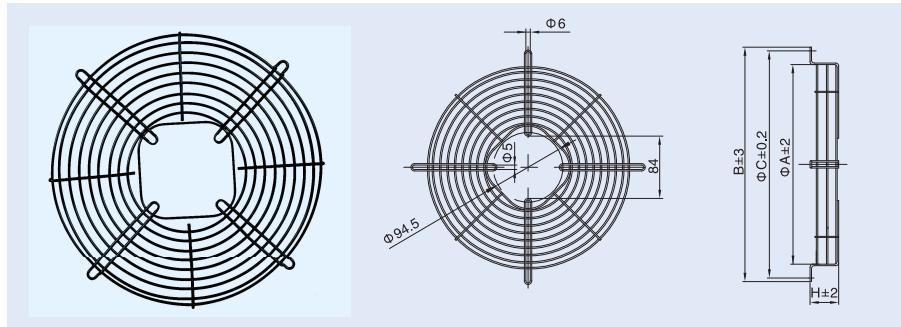

TIP	Φ 154	Φ 172	Φ 200	Φ 230	Φ 254	Φ 300
A	170	188	214	246	270	324
B	202	220	248	278	302	356
C	190	208	236	266	290	344
H	11	11	25	27	17	17

BRACKET / MONTAJ AYIĞI

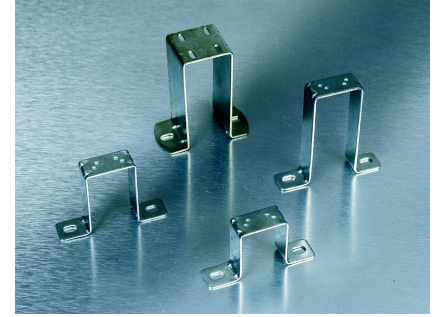
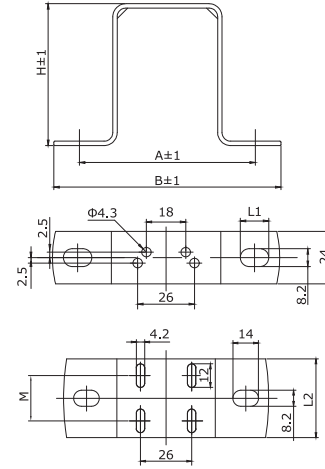

TIP	H	A	B	L1	L2	M
H39	39	78	100	14	-	-
H55	55	81	106	13	-	-
H72	72	81	106	13	-	-
H84	84	81	106	20	-	-
H92	92	81	106	14	-	-
H109-1	109	81	106	14	-	-
H109-2	109	78	100	14	39	21
H109-3	109	78	100	14	49	29

RING / SÜTLÜK ÇEMBERİ

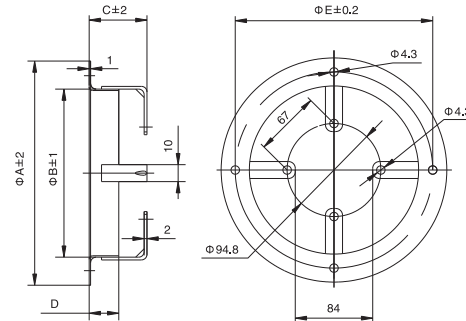

EMİŞ

TIP	Φ A	Φ B	C	D	Φ E
Φ 154	200	162	49	25	190
Φ 172	223	180	49	25	208
Φ 200	246	208	49	25	236
Φ 230	278	238	49	25	266
Φ 254	300	268	49	25	290
Φ 300	378	308	49	30	365

YZF C ÇERÇEVE MOTORLAR

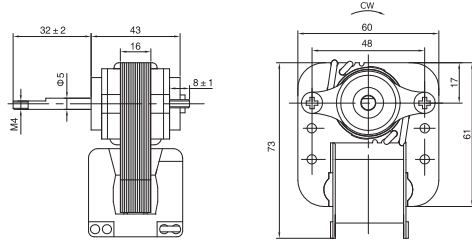

TİP	VOLTAJ	FREKANS	AKIM	GİRİŞ GÜCÜ	HIZ	DÖNÜŞ YÖNÜ	MİL	
	(V)	(Hz)	(A)	(W)	DEV/DAK	DEV/DAK	UZUNLUK	ÇAP
YZF024	220-240	50/60	0.21	24	2300	SAAT YÖNÜ	32 ± 2	φ 5

YZF C ÇERÇEVE MOTORLAR

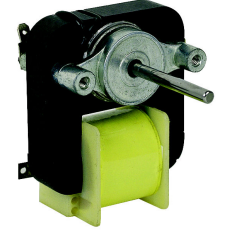
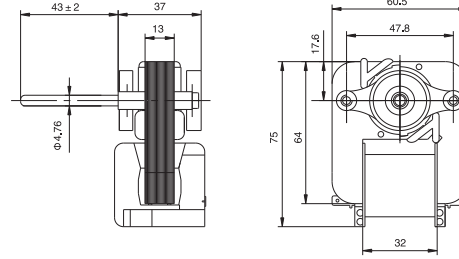

TİP	VOLTAJ	FREKANS	AKIM	GİRİŞ GÜCÜ	HIZ	DÖNÜŞ YÖNÜ	MİL		SERTİFİKA
	V	(Hz)	A	W	DEV/DAK	DEV/DAK	UZUNLUK	ÇAP	
YZF334/YZF335	120	60	0.45	15	3000	CW/CCW	43 ± 2	φ 4.76	RU®

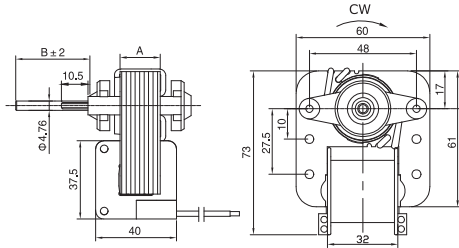
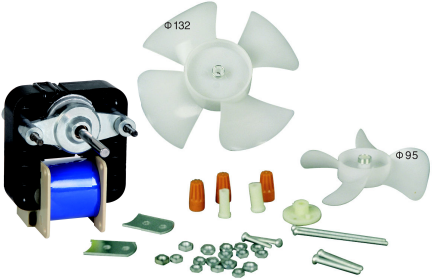

TİP	VOLTAJ	FREKANS	AKIM	GİRİŞ GÜCÜ	HIZ	DÖNÜŞ YÖNÜ	MİL		A	SERTİFİKA
	V	(Hz)	A	W	DEV/DAK	DEV/DAK	UZUNLUK	ÇAP		
YZF670	120	60	0.48	23	2500	CW/CCW	40 ± 2	φ 4.76	16	RU®
YZF672	240	50	0.30	23	2500	CW/CCW	40 ± 2	φ 4.76	16	RU®
YZF673	120	60	0.53/0.32	27/19	2900/2600	CW/CCW	40 ± 2	φ 4.76	16	
YZF675	120/240	50/60	0.50/0.35	32/35	3200/2800	CW/CCW	54 ± 2	φ 4.76	26	

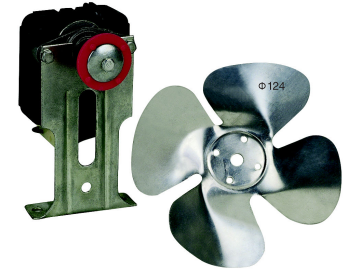
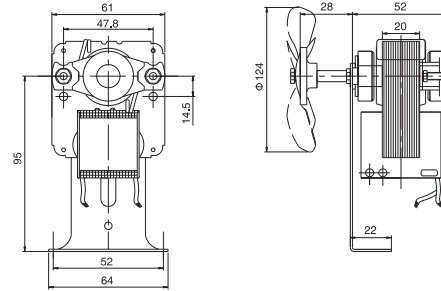

TİP	VOLTAJ	FREKANS	AKIM	GİRİŞ GÜCÜ	HIZ	DÖNÜŞ YÖNÜ	MİL	
	V	(Hz)	A	W	DEV/DAK	DEV/DAK	UZUNLUK	ÇAP
YZF3213	127	60	0.28	17	2800	CCW	28 ± 2	φ 6
YZF3206	220	50/60	0.23	25	2600	CCW	28 ± 2	φ 6

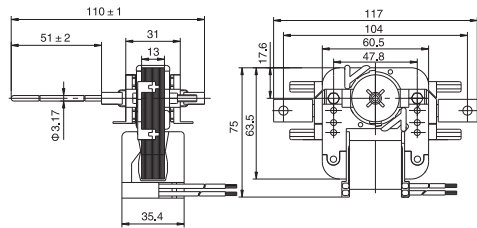
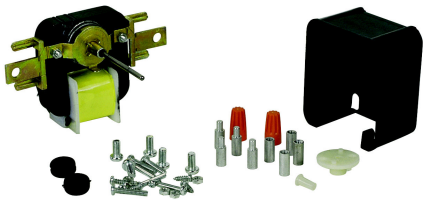

TİP	VOLTAJ	FREKANS	AKIM	GİRİŞ GÜCÜ	HIZ	DÖNÜŞ YÖNÜ	MİL		SERTİFİKA
	V	(Hz)	A	W	DEV/DAK	DEV/DAK	UZUNLUK	ÇAP	
YZF999	120	60	0.45	16	3000	CW/CCW	51 ± 2	φ 3.17	RU®
YZF998	240	50	0.20	18	2600	CW/CCW	51 ± 2	φ 3.17	RU®

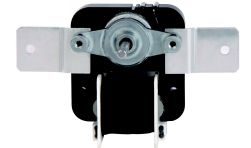
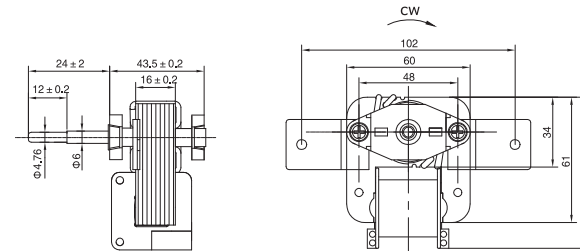

TİP	VOLTAJ	FREKANS	AKIM	GİRİŞ GÜCÜ	HIZ	DÖNÜŞ YÖNÜ	MİL		FAN KANADI
	V	(Hz)	(A)	(W)	DEV/DAK	DEV/DAK	UZUNLUK	ÇAP	
D22120	127	60	0.14	9	3100	CW/CCW	24 ± 2	φ 4.76	φ 102
D22121	220	60	0.10	11	3100	CW/CCW	24 ± 2	φ 4.76	φ 102

YZF C ÇERÇEVE MOTORLAR

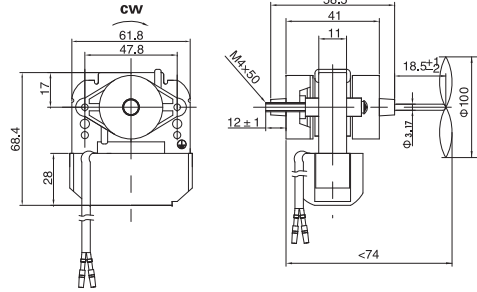

TYPE	VOLTAJ V	FREKANS (Hz)	AKIM A	GİRİŞ GÜCÜ W	HIZ DEV/DAK	DÖNÜŞ YÖNÜ DEV/DAK	MİL UZUNLUK	ÇAP
YZF00822	220	50	0.06	6	2000	CW	18.5 ± 2	φ 3.17

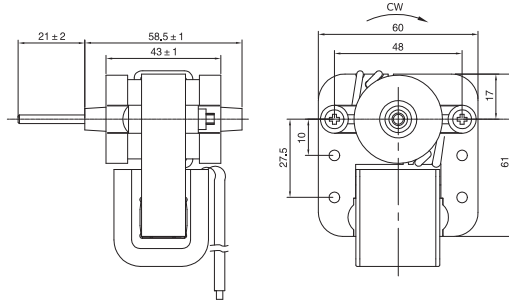

TİP	FREKANS (Hz)	AKIM (A)	GİRİŞ GÜCÜ (W)	HIZ DEV/DAK	DÖNÜŞ YÖNÜ DEV/DAK	MİL UZUNLUK	ÇAP	FAN KANADI
YZF61-13-1	220	0.15	11	2600	CW/CCW	21 ± 2	φ 3.17	φ 100
YZF61-13-2	220	0.12	8	2200	CW/CCW	21 ± 2	φ 3.17	φ 100

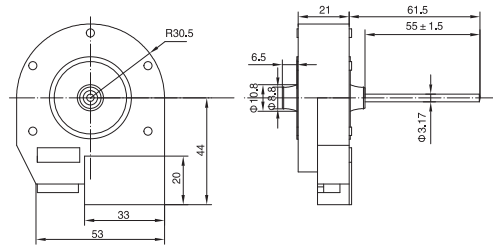
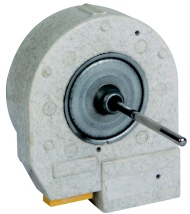

TİP	VOLTAJ V	AKIM (A)	GİRİŞ GÜCÜ (W)	HIZ DEV/DAK	DÖNÜŞ YÖNÜ DEV/DAK	FAN KANADI
ECM58-05	12	0.17	2	2800	CW	φ 100
ECM58-05	12	0.33	4	1500	CCW	φ 150

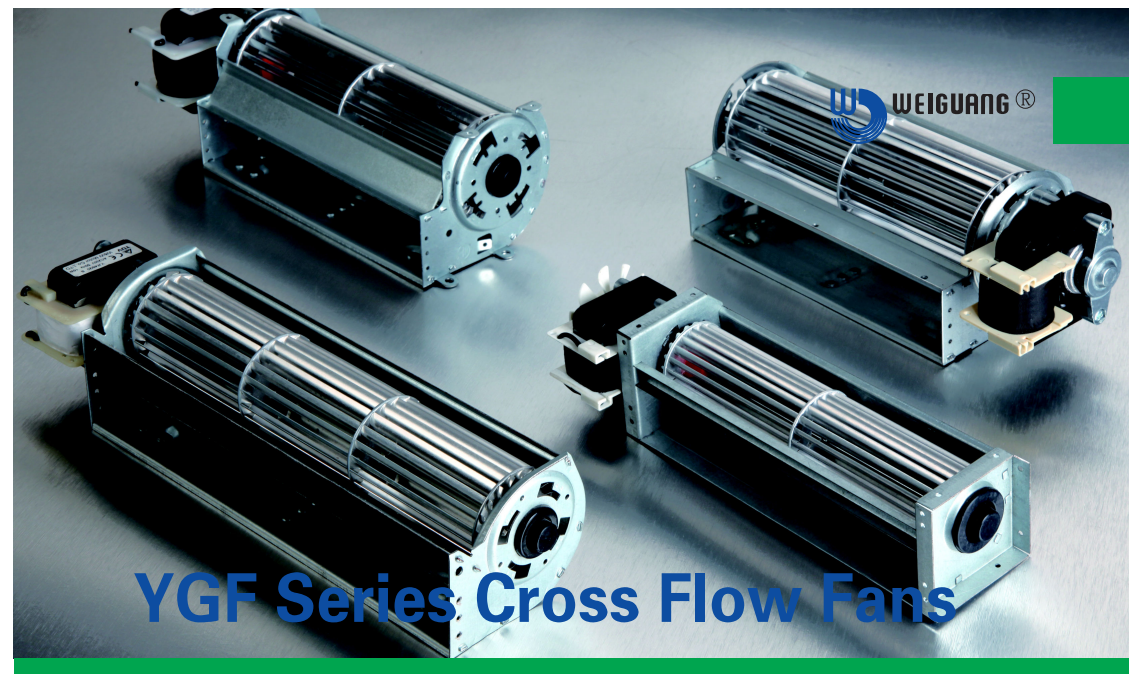

YZF Series Cross Flow Fans

YGF SERİSİ RADYAL FANLAR

YGF serisi Radyal fanların en önemli özelliği; fan pervanesinin üzerinden aynı hava 2 kere döner. Radyal dönüş doğrultusunda hava hava girişi olur ve yine hava çıkışı olur. Giriş ve çıkış hava debileri aynı düzlemedir ve çıkış havası pervane tarafından aynı tek tip yapıda doğrultularak yatay olarak verilir. Bu ürünler, klima sistemlerinde, Hava perdelerinde, kurutma makinelerinde ve ev tipi cihazlarda, kompakt yapısı, yüksek dinamik verimliliğe sahip geniş bir hava debisine sahip olduğundan ötürü tercih edilir. ROHS standardına uygun malzemelerden imal edilmiştir. Fan motorlarının izolasyon sınıfı B dir ve talep üzerine, F sınıfı veya H sınıfı radyalfanlar da tedarik edilebilir. Radyal fanlarımızın çalışılabilir ortam ısısı -30 °C ile 50 °C arasında değişebilmektedir. Radyal fanlarımız için ortalama çalışma ömrü 20000 saatin üzerindedir. Fanı çalıştırmadan önce topraklama kablosunu uygun şekilde toprak hattına bağlandığından emin olunuz.

Model Adlandırması Illustration of model

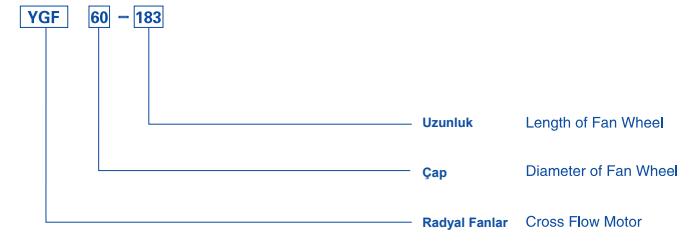

YG SERİSİ RADYAL FANLAR

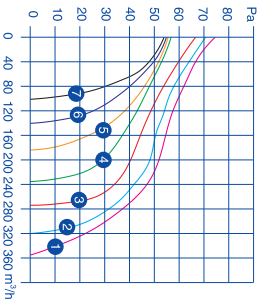
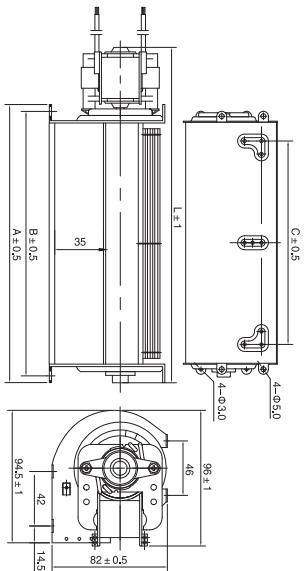

TIP	V	FREKANS	AKIM	GİRİŞ GÜCÜ	HIZ	DEBİ	A	B	C	L	EĞRİ NOSU
YGFB0,480	220	50	0,42	48	2200	354	505	495	450,5	576	1
YGFB0,420	220	50	0,40	45	2300	310	445	435	390,5	516	2
YGFB0,360	220	50	0,38	43	2400	270	385	375	330,5	456	3
YGFB0,300	220	50	0,27	29	2150	230	325	315	270,5	382	4
YGFB0,240	220	50	0,25	27	2300	175	285	255	210,5	322	5
YGFB0,183	220	50	0,20	20	2100	140	206	196	153,5	253	6
YGFB0,120	220	50	0,19	18	2300	92	145	135	90,5	192	7

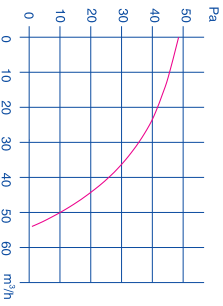
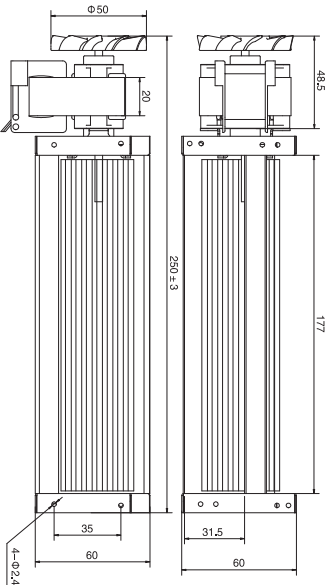

TIP	MODEL	VOLTAJ	FREKANS	GİRİŞ GÜCÜ	AKIM	HIZ	AĞIRLIK	SERTİFİKA
YGFB48-180	YZF5505	220-240	50	7.2	0.06	2000	0.3	CCC

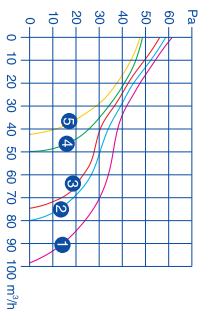
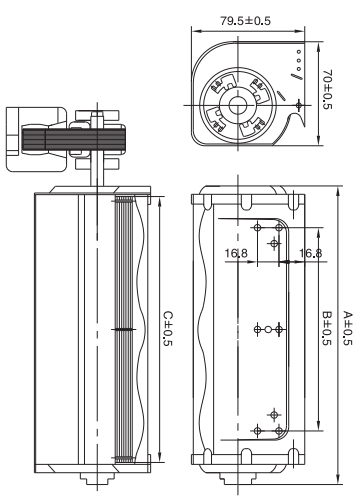

TIP	V	FREKANS	AKIM	GİRİŞ GÜCÜ	HIZ	DEBİ	A	B	C	EĞRİ NOSU
YGF45,360	220	50	0,15	17,5	1500	98,0	383	328	360	1
YGF45,300	220	50	0,13	15,0	1200	80,0	323	288	300	2
YGF45,290	220	50	0,12	14,0	1500	76,8	313	258	290	3
YGF45,186	220	50	0,11	13,0	1500	50,0	209	154	186	4
YGF45,150	220	50	0,10	11,0	1500	42,0	173	118	150	5

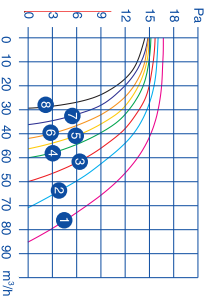
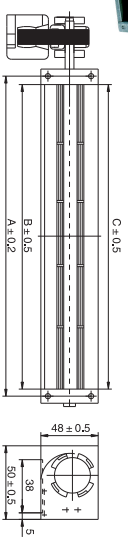

TIP	V	H	AKIM	GİRİŞ GÜCÜ	HIZ	DEBİ	A	B	C	EĞRİ NOSU
YGF30,365	220	50	0,095	13,0	2300	85	379	363	355	1
YGF30,300	220	50	0,080	11,0	2300	72	323	308	300	2
YGF30,250	220	50	0,070	9,0	2300	60	283	258	250	3
YGF30,210	220	50	0,060	8,0	2300	48	223	218	210	4
YGF30,200	220	50	0,056	7,7	2300	48	223	208	200	5
YGF30,180	220	50	0,050	6,6	2300	43	203	188	150	6
YGF30,150	220	50	0,040	5,5	2300	36	173	158	150	7
YGF30,120	220	50	0,030	4,4	2300	29	143	128	120	8

YJF-8025 SERİSİ KARE FANLAR

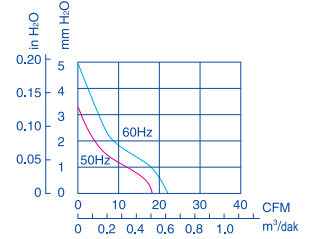
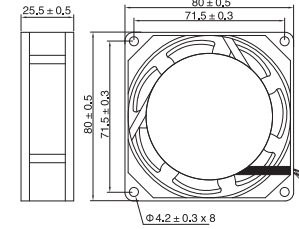

TIP	YATAK TIPI	BAGLANTI	VOLTAJ	FREKANS	GİRİŞ GÜCÜ	AKIM	HIZ	DEBİ		SATATIK BASINÇ	SES	AĞIRLIK	SERTİFİKA
			V	Hz	W	A	r/min	m³/min	CFM	mmH ₂ O	dBA	kg	
8025HB	RULMANLI	KABLO	220~240	50/60	11/9	0.065/0.055	2500/2900	0.51/0.62	18/22	3.30/4.83	29/33	0.24	CE UL
8025HS	MAN.YAT.	KABLO	220~240	50/60	11/9	0.065/0.055	2300/2700	0.51/0.62	18/22	3.30/4.83	29/33	0.24	CE UL
8025HB	RULMANLI	KABLO	110~120	50/60	12/11	0.12/0.10	2500/2900	0.51/0.62	18/22	3.30/4.83	29/33	0.24	CE UL
8025HS	MAN.YAT.	KABLO	110~120	50/60	12/11	0.12/0.10	2500/2900	0.51/0.62	18/22	3.30/4.83	29/33	0.24	CE UL

YJF Series of Shaded Pole Motors

YJF SERİSİ KARE FANLAR

YJF serisi kare fanlar, kompakt yapı, hafif gövde, verimli montaj, düşük ses seviyesi, düşük manyetik etkileşim, güvenlik, uzun ömürlülük gibi karakteristik özelliklere sahiptir. Genelde soğutma cihazlarında, güç kaynağı devrelerinde, elektrikli kaynak makinelerinde ve bunun gibi havalandırma ve soğutma cihazlarında kullanılır. ROHS standardına uygun malzemelerden imal edilmiştir.

Çalışılabilir ortam ısısı;

Rulmanlı modellerde; -20 °C ile 60 °C arasında değişebilmektedir.

Manyetik yataklı modellerde; 0 °C ile 50 °C arasında değişebilmektedir.

Ortalama çalışma ömrü 20000 saatin üzerindedir.

Çoğu model, CE, UL sertifikalarına sahip olup CCC güvenlik onayından da geçmiştir.

Fanı çalıştırmadan önce topraklama kablosunu uygun şekilde toprak hattına bağlandığından emin olunuz.

Model Adlandırması Illustration of Model

YJF 120 38 HB 1 L

- L: Kablolu Cable
- T: Soketli Terminal
- 1: 110~120V
- 2: 220~240V
- HB Rulmanlı Ball bearing
- HS Manyetik Yataklı Sleeve bearing
- Çerçeve Kalınlığı (mm)
Thickness of machine frame
- Dış Sınır Çapı
Dimension of outline border
- Kare Fanlar
Mini-shaded pole fan motor

YJF-8038 SERİSİ KARE FANLAR

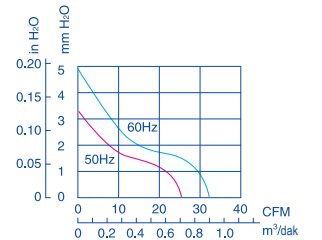
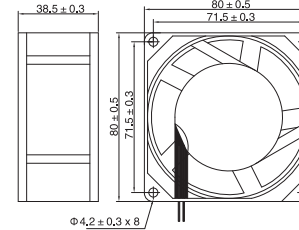

TIP	YATAK TIPI	BAGLANTI	VOLTAJ	FREKANS	GİRİŞ GÜCÜ	AKIM	HIZ	DEBİ		SATATIK BASINÇ	SES	AĞIRLIK	SERTİFİKA
			V	Hz	W	A	r/min	m³/min	CFM	mmH ₂ O	dBA	kg	
8038HB	RULMANLI	KABLO / SOKET	220~240	50/60	16/12	0.10/0.08	2400/2800	0.68/0.88	24/31	3.30/4.83	31/35	0.3	CE UL
8038HS	MAN.YAT.	KABLO / SOKET	220~240	50/60	16/12	0.10/0.08	2300/2700	0.68/0.88	24/31	3.30/4.83	31/35	0.3	CE UL
8038HB	RULMANLI	KABLO / SOKET	110~120	50/60	14/12	0.15/0.13	2400/2800	0.68/0.88	24/31	3.30/4.83	31/35	0.3	CE UL
8038HS	MAN.YAT.	KABLO / SOKET	110~120	50/60	14/12	0.15/0.13	2400/2800	0.68/0.88	24/31	3.30/4.83	31/35	0.3	CE UL

YJF-9225 SERİSİ KARE FANLAR

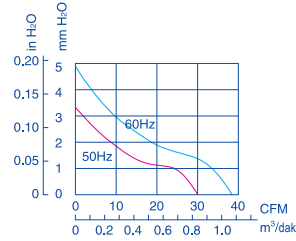
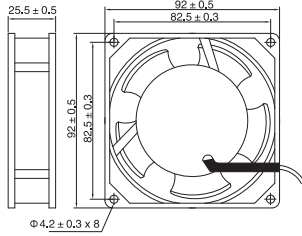

TIP	YATAK TİPİ	BAĞLANTI	VOLTAJ	FREKANS	GİRİŞ GÜCÜ	AKIM	HIZ	DEBİ		SATATIK BASINÇ	SES	AĞIRLIK	SERTİFİKA
								m³/min	CFM				
9225HB	RULMANLI	KABLO / SOKET	220~240	50/60	11.5/9.5	0.065/0.055	2300/2600	0.85/1.05	30/37	3.30/4.83	32/37	0.28	CE UL
9225HS	MAN.YAT.	KABLO / SOKET	220~240	50/60	11.5/9.5	0.065/0.055	2300/2600	0.85/1.05	30/37	3.30/4.83	32/37	0.28	CE UL
9225HB	RULMANLI	KABLO / SOKET	110~120	50/60	13/12	0.12/0.11	2500/2900	0.85/1.05	30/37	3.30/4.83	32/37	0.28	CE UL
9228HS	MAN.YAT.	KABLO / SOKET	110~120	50/60	13/12	0.12/0.11	2500/2900	0.85/1.05	30/37	3.30/4.83	32/37	0.28	CE UL

YJF-11025 SERİSİ KARE FANLAR

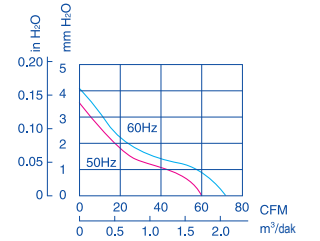
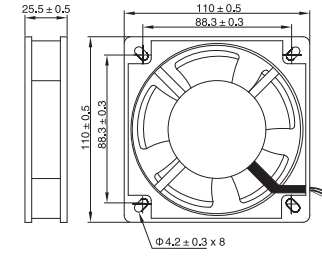

TIP	YATAK TİPİ	BAĞLANTI	VOLTAJ	FREKANS	GİRİŞ GÜCÜ	AKIM	HIZ	DEBİ		SATATIK BASINÇ	SES	AĞIRLIK	SERTİFİKA
								m³/min	CFM				
11025HB	RULMANLI	KABLO	220~240	50/60	12.5/10	0.065/0.055	1900	1.70/2.01	60/71	3.56/4.06	36/38	0.33	CE
11025HS	MAN.YAT.	KABLO	220~240	50/60	12.5/10	0.065/0.055	1700	1.70/2.01	60/71	3.56/4.06	36/38	0.33	CE
11025HB	RULMANLI	KABLO	110~120	50/60	15/12	0.17/0.14	2100/2300	1.70/2.01	60/71	3.56/4.06	36/38	0.33	CE
11025HS	MAN.YAT.	KABLO	110~120	50/60	15/12	0.17/0.14	2100/2300	1.70/2.01	60/71	3.56/4.06	36/38	0.33	CE

YJF-9238 SERİSİ KARE FANLAR

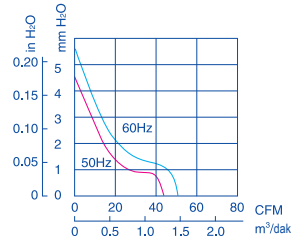
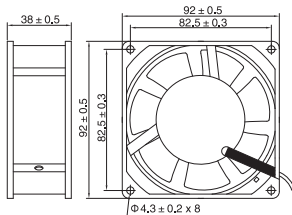

TIP	YATAK TİPİ	BAĞLANTI	VOLTAJ	FREKANS	GİRİŞ GÜCÜ	AKIM	HIZ	DEBİ		SATATIK BASINÇ	SES	AĞIRLIK	SERTİFİKA
								m³/min	CFM				
9238HB	RULMANLI	KABLO	220~240	50/60	17/12	0.12/0.09	2300/2800	1.20/1.35	43/49	4.50/5.50	32/37	0.40	CE
9238HS	MAN.YAT.	KABLO	220~240	50/60	17/12	0.12/0.09	2200/2600	1.20/1.35	43/49	4.50/5.50	32/37	0.40	CE
9238HB	RULMANLI	KABLO	110~120	50/60	18	0.22	2400	1.20/1.35	43/49	4.50/5.50	32/37	0.40	CE
9238HS	MAN.YAT.	KABLO	110~120	50/60	18	0.22	2400	1.20/1.35	43/49	4.50/5.50	32/37	0.40	CE

YJF-12025 SERİSİ KARE FANLAR

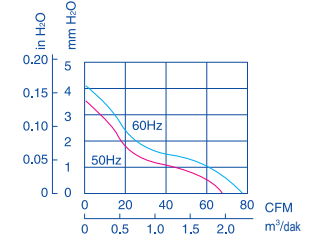
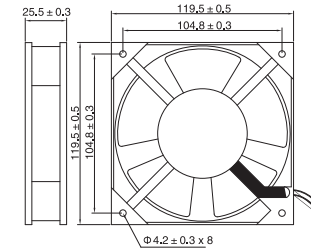
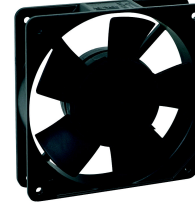

TIP	YATAK TİPİ	BAĞLANTI	VOLTAJ	FREKANS	GİRİŞ GÜCÜ	AKIM	HIZ	DEBİ		SATATIK BASINÇ	SES	AĞIRLIK	SERTİFİKA
								m³/min	CFM				
12025HB	RULMANLI	KABLO / SOKET	220~240	50/60	12/10	0.065/0.055	1950	1.87/2.21	66/78	3.56/4.06	38/40	0.33	CE UL
12025HS	MAN.YAT.	KABLO / SOKET	220~240	50/60	12/10	0.065/0.055	1700	1.87/2.21	66/78	3.56/4.06	38/40	0.33	CE UL
12025HB	RULMANLI	KABLO / SOKET	110~120	50/60	19/18	0.19/0.18	2200/2400	1.87/2.21	66/78	3.56/4.06	38/40	0.33	CE UL
12025HS	MAN.YAT.	KABLO / SOKET	110~120	50/60	19/18	0.19/0.18	2200/2400	1.87/2.21	66/78	3.56/4.06	38/40	0.33	CE UL

YJF-12038 SERİSİ KARE FANLAR

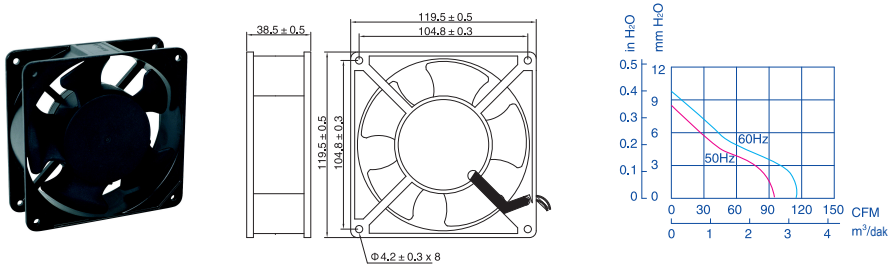

TIP	YATAK TİPİ	BAĞLANTI	VOLTAJ V	FREKANS Hz	GİRİŞ GÜCÜ W	AKIM A	HIZ r/min	DEBİ		SATATİK BASINÇ mmH ₂ O	SES dB	AĞIRLIK kg	SERTİFİKA
								m ³ /min	CFM				
12038HB	RULMANLI	KABLO / SOKET	220-240	50/60	20/17	0.13/0.11	2600/2800	2.58/3.20	91/113	6.35/7.62	40/45	0.48	CE UL
12038HS	MAN.YAT.	KABLO / SOKET	220-240	50/60	20/17	0.13/0.11	2600/2800	2.58/3.20	91/113	6.35/7.62	40/45	0.48	CE UL
12038HB	RULMANLI	KABLO / SOKET	110-120	50/60	21/18	0.22/0.18	2600/2900	2.58/3.20	91/113	6.35/7.62	40/45	0.48	CE UL
12038HS	MAN.YAT.	KABLO / SOKET	110-120	50/60	21/18	0.22/0.18	2600/2900	2.58/3.20	91/113	6.35/7.62	40/45	0.48	CE UL
12038HB	RULMANLI	KABLO / SOKET	380	50	18	0.06	2600	2.58	91	6.35	40	0.48	CE
12038HS	MAN.YAT.	KABLO / SOKET	380	50	18	0.06	2600	2.58	91	6.35	40	0.48	CE

YJF-15050 SERİSİ KARE FANLAR

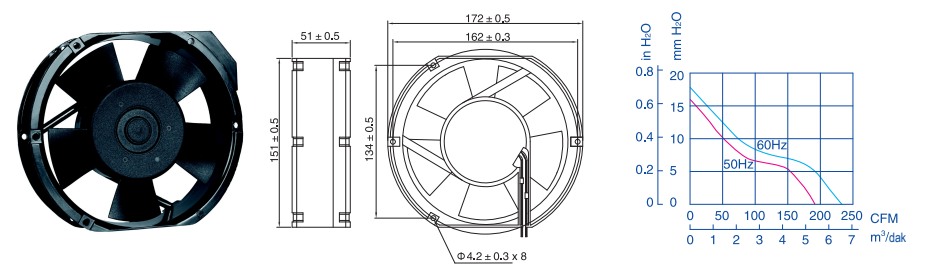

TIP	YATAK TİPİ	BAĞLANTI	VOLTAJ V	FREKANS Hz	GİRİŞ GÜCÜ W	AKIM A	HIZ r/min	DEBİ		SATATİK BASINÇ mmH ₂ O	SES dBA	AĞIRLIK kg	SERTİFİKA
								m ³ /min	CFM				
15050HB	RULMANLI	KABLO / SOKET	220-240	50	36	0.24	2600	5.37	190	16.00	45	1.00	CE UL
15050HS	MAN.YAT.	KABLO / SOKET	220-240	50	36	0.24	2600	5.37	190	16.00	45	1.00	CE UL
15050HB	RULMANLI	KABLO / SOKET	110-120	50/60	37/36	0.50/0.45	2700/3100	5.37/6.65	190/235	16.00/17.78	45/50	1.00	CE UL
15050HS	MAN.YAT.	KABLO / SOKET	110-120	50/60	37/36	0.50/0.45	2700/3100	5.37/6.65	190/235	16.00/17.78	45/50	1.00	CE UL
15050HB	RULMANLI	KABLO / SOKET	380	50	34	0.11	2700	5.37	190	16.00	45	1.00	CE
15050HS	MAN.YAT.	KABLO / SOKET	380	50	34	0.11	2700	5.37	190	16.00	45	1.00	CE

YJF-12038-7 SERİSİ KARE FANLAR

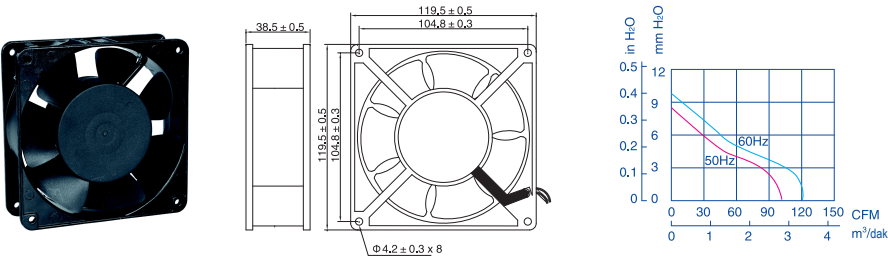

TIP	YATAK TİPİ	BAĞLANTI	VOLTAJ V	FREKANS Hz	GİRİŞ GÜCÜ W	AKIM A	HIZ r/min	DEBİ		SATATİK BASINÇ mmH ₂ O	SES dBA	AĞIRLIK kg	SERTİFİKA
								m ³ /min	CFM				
12038HB-7	RULMANLI	KABLO / SOKET	220-240	50/60	20/18	0.13/0.11	2500	2.72/3.37	96/119	6.67/8.01	40/45	0.48	CE UL
12038HS-7	MAN.YAT.	KABLO / SOKET	220-240	50/60	20/18	0.13/0.11	2500	2.72/3.37	96/119	6.67/8.01	40/45	0.48	CE UL
12038HB-7	RULMANLI	KABLO / SOKET	110-120	50/60	21/18	0.26/0.24	2400	2.72/3.37	96/119	6.67/8.01	40/45	0.48	CE UL
12038HS-7	MAN.YAT.	KABLO / SOKET	110-120	50/60	21/18	0.26/0.24	2400	2.72/3.37	96/119	6.67/8.01	40/45	0.48	CE UL
12038HB-7	RULMANLI	KABLO / SOKET	380	50	18	0.06	2500	2.72	96	6.67	40	0.48	CE
12038HS-7	MAN.YAT.	KABLO / SOKET	380	50	18	0.06	2500	2.72	96	6.67	40	0.48	CE

YJF-22060 SERİSİ KARE FANLAR

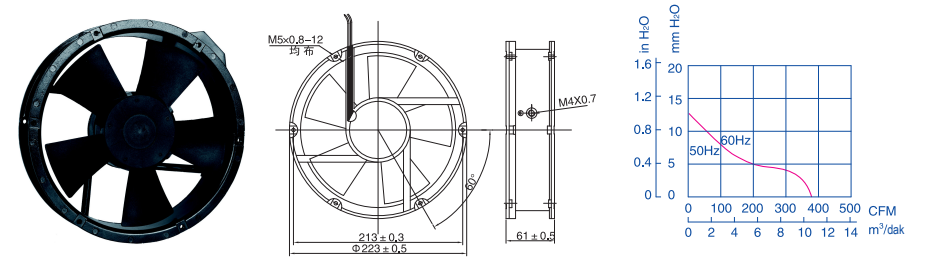

TIP	YATAK TİPİ	BAĞLANTI	VOLTAJ V	FREKANS Hz	GİRİŞ GÜCÜ W	AKIM A	HIZ r/min	DEBİ		SATATİK BASINÇ mmH ₂ O	SES dBA	AĞIRLIK kg	SERTİFİKA
								m ³ /min	CFM				
22060HB	RULMANLI	KABLO / SOKET	220-240	50	45	0.30	2200	11	388	25.4	56	1.60	CE
22060HB	RULMANLI	KABLO / SOKET	110-120	50/60	57/58	0.76/0.77	2400	11	388	25.4	56	1.60	CE
22060HB	RULMANLI	KABLO / SOKET	380	50	47	0.16	2400	11	388	25.4	56	1.60	CE